

Ecoguard Type W Dust Collection Cover Instruction Manual

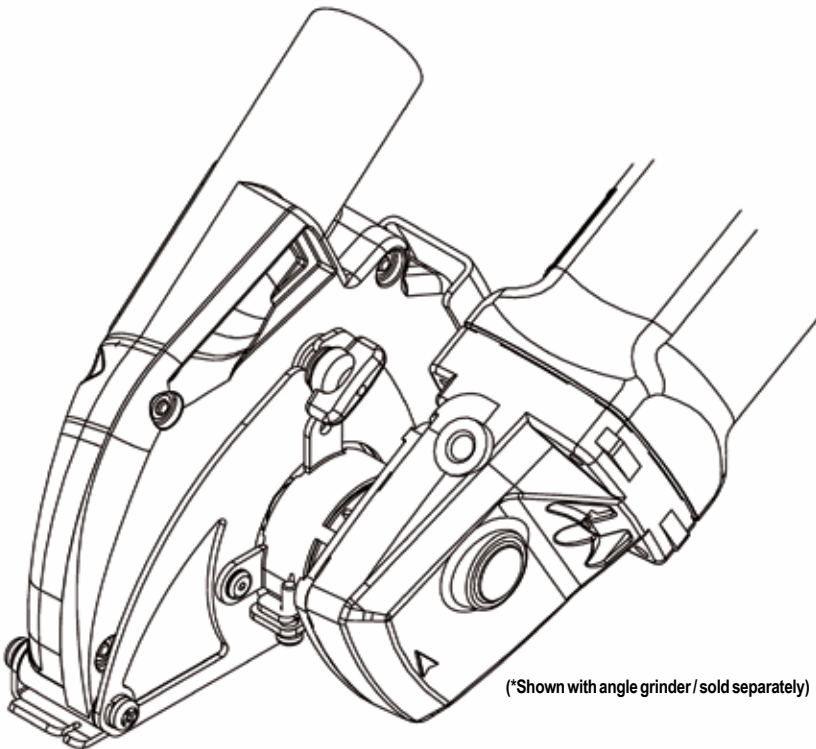

(*Shown with angle grinder / sold separately)

**Part No: ECOGRDCW
Version 2**

►TABLE OF CONTENTS

Introduction.....3

About the Symbols3

Ecoguard Type W Overview4

Accessories4

Connectors & Flanges5

Installation of the Dust Collection Cover.....6

Installing to Makita® High-speed Angle Grinder6

Installing to other High-speed Angle Grinders with
included other connectors7

Mounting the Diamond Wheel7

Adjusting the Cutting Depth.....8

Attaching the Dust Collector9

Ecoguard Type W Schematic10

Ecoguard Type W Parts List.....11

► INTRODUCTION

Thank you for purchasing the Ecoguard “Type W” Dust Collection Cover. The Ecoguard Type W must be used with a vacuum, or other dust collection system. To ensure correct use, read this Instruction Manual and the Instruction Manual for the power tool and follow the operating instructions. Keep this manual in a place where operators can access it easily whenever necessary!

► ABOUT THE SYMBOLS

According to the hazard level, all safety notes in this manual are classified into “DANGER”, “WARNING”, and “CAUTION”.

 **DANGER!** Death or serious personal injury is imminent when handling this polisher incorrectly.

 **WARNING!** There is a possibility of death or serious personal injury when handling this polisher incorrectly.

 **CAUTION!** There is a possibility of personal injury or property damage when handling this polisher incorrectly.

Note: In some situations, failing to observe **WARNING** notes could result in death or serious personal injury. Be sure to read and observe the safety notes to ensure safety and correct use of the polisher.

► PRECAUTIONS FOR USING DUST COLLECTION COVER

1. The Dust Collection Cover is for use with a 4.5" (115mm) and 5" (125mm) high-speed angle grinder.
2. The Dust Collection Cover is designed for cutting concrete, stone and other masonry products. Do not use when cutting metal or other materials.
3. The Dust Collection Cover is solely designed for use with a diamond cutting wheel. Do not use with any other type of blade such as a conventional abrasive blade or carbide tip saw blade.
4. Always check the Dust Collection Cover for damage, cracks or deformation before starting work. Do not use the Dust Collection Cover if it is damaged, cracked or bent as this could cause to injury.
5. Always wear eye protection. Dust mask, nonskid safety shoes, hard hat, or hearing protection must be used for appropriate conditions.
6. Keep the Dust Collection Cover away from gasoline, thinner, petroleum and paraffin.
7. The supplied connector may not connect securely to every high-speed angle grinder. In this case, do not use the Dust Collection Cover.

► **ECOGUARD TYPE W OVERVIEW**

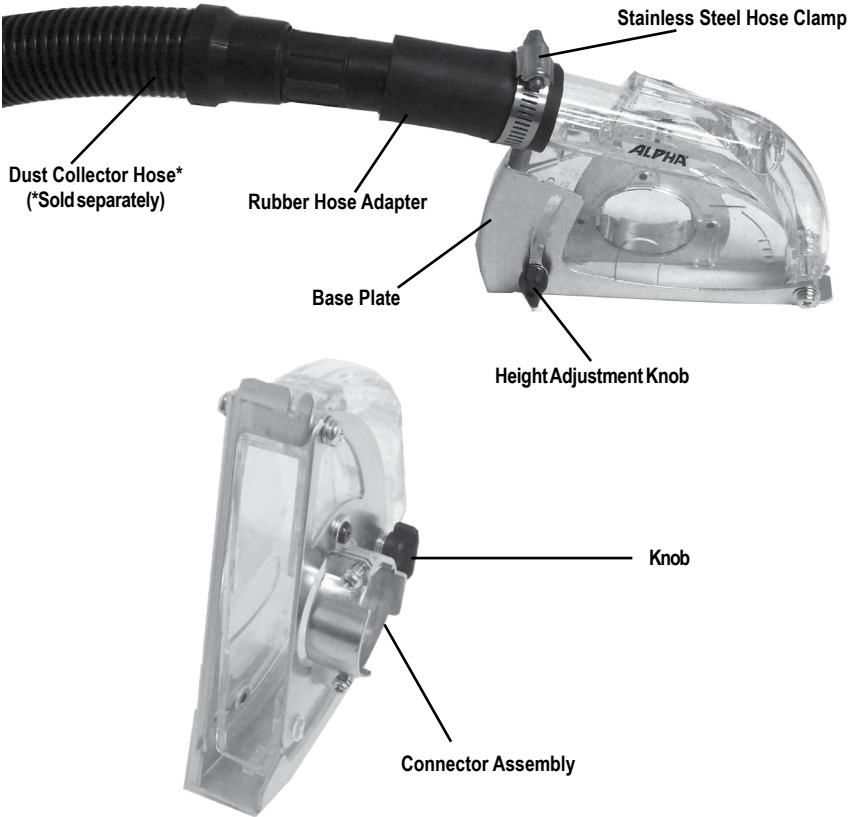

► **ACCESSORIES**

Ecoguard Dust Collection Cover w/ Connector (Part# 500002)	1 pc
Collar.....	2 pcs
Additional Connector Assembly for Most 5" Grinders	3 pcs
Flange and Locknut Set for Selective Grinders.....	1 set
Hex Wrench.....	1 pc
Rubber Hose Adapter.....	1 pc
Spacers.....	2 pcs
Stainless Steel Hose Band	1 pc
Pin Wrench.....	1 pc

ATTACHABLE GRINDERS

GRINDER	SIZE	MODEL
	5"	HSG-125
MAKITA	4-1/2"	GA4530
		GA4534
		9564CV
		9564PC
		9557NB
		9557PB
	5"	GA5010Z
		GA5020
		GA5020Y
		9558PB
		9565CV
		9565PC
	6"	GA6020
		GA6010Z
		9566CV
		9566PC
HITACHI	4-1/2"	G12SA3
		G12SE2
		G12SE2P9
		G12SVA
		G12SR3
		G12SS
	5"	G13SC2
		G13SC2P9
		G13SP
		G13VA

ATTACHABLE GRINDERS (CONT'D)

GRINDER	SIZE	MODEL
BOSCH	4-1/2"	1800
		1810PS
		1810PSD
	5"	1801
		1803EVS
		1811PS
		1821
		1821D
	6"	1806E
		1812PSD
METABO	4-1/2"	W8-115
		W8-115 Quick
		W8-115 QuickProtect
	5"	W8-125 Quick
		W11-125 Quick
		WA11-125 Quick
		WE9-125 Quick
		WE14-125 Plus
		WE14-125 VS
		WP8-125 QuickProtect
		WP11-125 QuickProtect
		WEPA14-125 QuickProtect
	6"	W11-150 Quick
		WE14-150 Quick
		WEP14-150 QuickProtect
		WEPA14-150 QuickProtect
		WP11-150 QuickProtect

ATTACHABLE GRINDERS

GRINDER	SIZE	MODEL
DEWALT	4-1/2"	D28110
		D28112
		D28402
	4-1/2" / 5"	D28065
		D28114
		D28115
		D28131
	6"	D28140
		D28144
MILWAUKEE	4-1/2"	6130-33
		6140-30
		6146-30
		6146-31
		6146-33
		6147-30
		6147-31
		6121-30
		6121-31
	5"	6117-30
		6117-31
		6117-33
		6117-33D
		6121-31A
	6"	6124-30
		6124-31
		6161-30
		6161-31
		6161-33

► ECOGUARD TYPE W SPACERS AND CONNECTORS

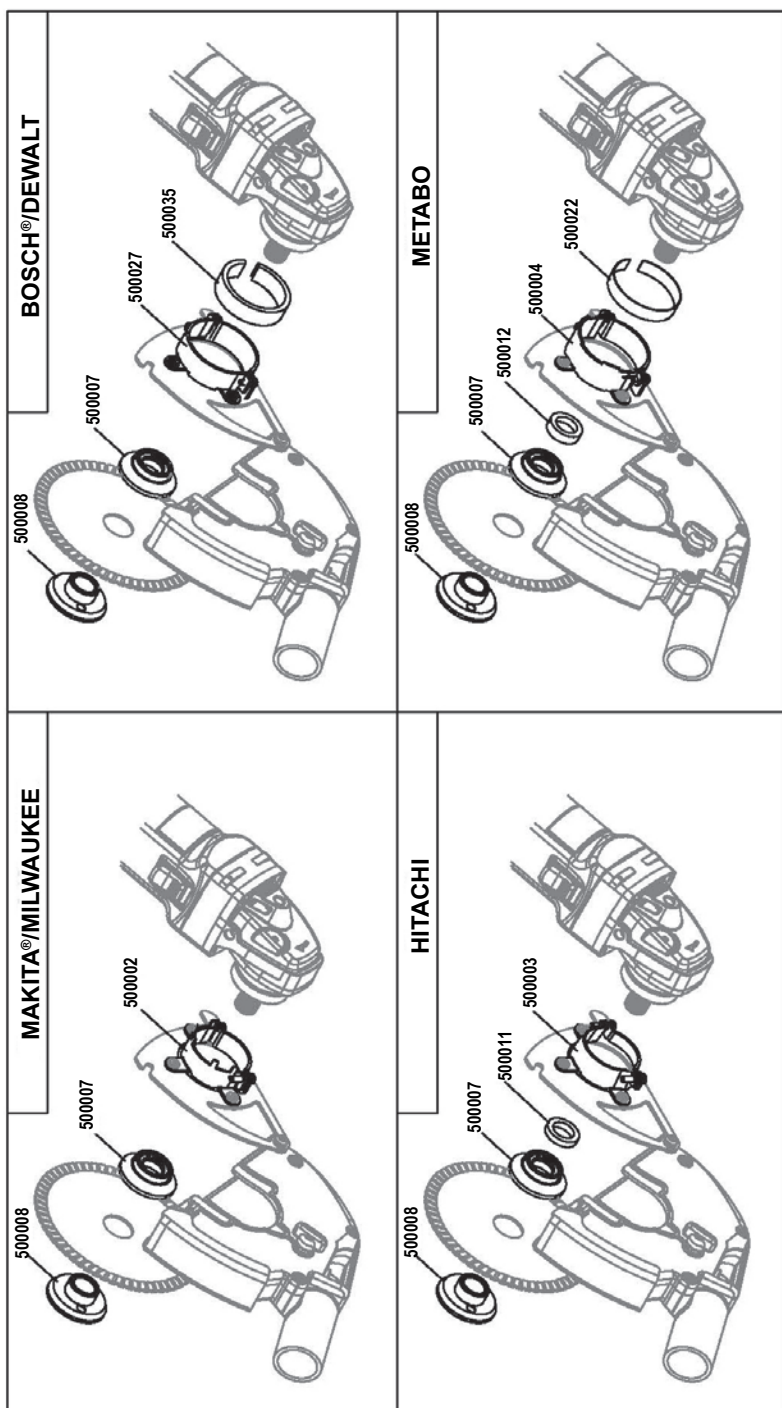

► INSTALLATION OF THE DUST COLLECTION COVER

WARNING!

1. Be sure to turn off the high-speed angle grinder and remove the plug from the electrical outlet before attaching and installing the Dust Collection Cover.
2. Make sure the Dust Collection Cover is securely attached; otherwise it may come loose which could cause injury.
3. If you installed the Dust Collection Cover to a high-speed angle grinder but the connector is loose and can not be securely attached, do not use the Dust Collection Cover. Using it in this state could cause injury.

► INSTALLING TO MAKITA® HIGH-SPEED ANGLE GRINDER

1. Dismantle the original safety guard and diamond cutting wheel from the high-speed angle grinder.
2. Loosen the connector setting screws in the Dust Collection Cover and leave loose.
3. Attach the connector to the wheel guard mount of the high-speed angle grinder. Adjust the angle of the Dust Collection Cover when attaching. (Fig. 1)
4. Using a Phillips screwdriver, tighten the two setting screws securely. (Fig. 2)

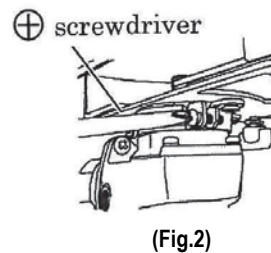
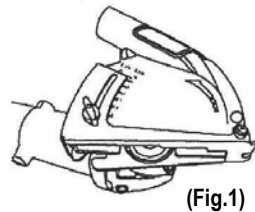

CAUTION!

This Dust Collection Cover is solely designed for application with diamond wheel. Do not use with any other type of tool such as a conventional abrasive cut-off wheel or carbide tip saw blade.

► INSTALLING TO OTHER HIGH-SPEED ANGLE GRINDERS WITH INCLUDED OTHER CONNECTORS

If you install the Dust Collection Cover to a high-speed angle grinder but the connector is loose and cannot be securely attached, it may be necessary to change the connector designed for other makes.

1. Using the hexagon Wrench, remove the three bolts in the connector attached to the Dust Collection Cover. (Fig. 3)
2. Attach the supplied connector by following the instruction in (1) above in reverse. (For Hitachi Grinder use Part No: 500003/ for Metabo / Bosch use Part No: 500004)
3. Subsequent procedures are the same as for attaching the adapter to a high-speed angle grinder in case changing the connector is not needed.

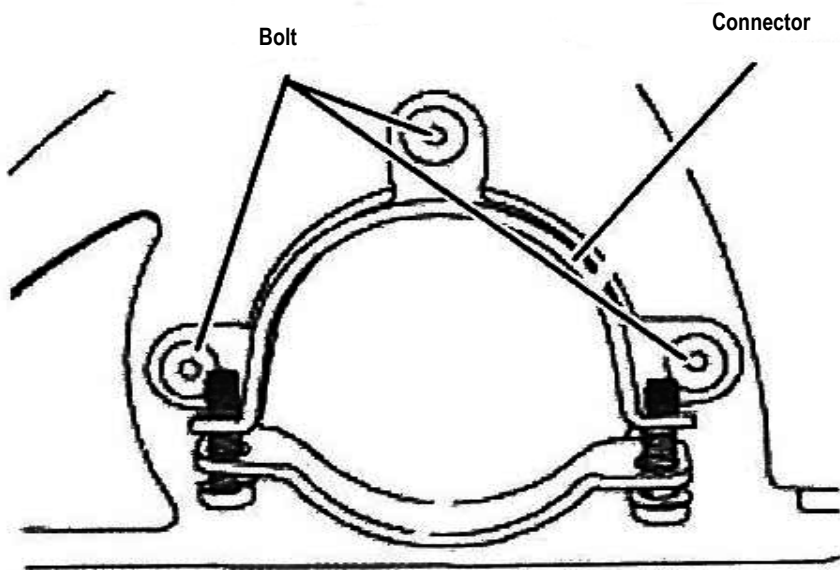

(Fig.3)

► MOUNTING THE DIAMOND WHEEL

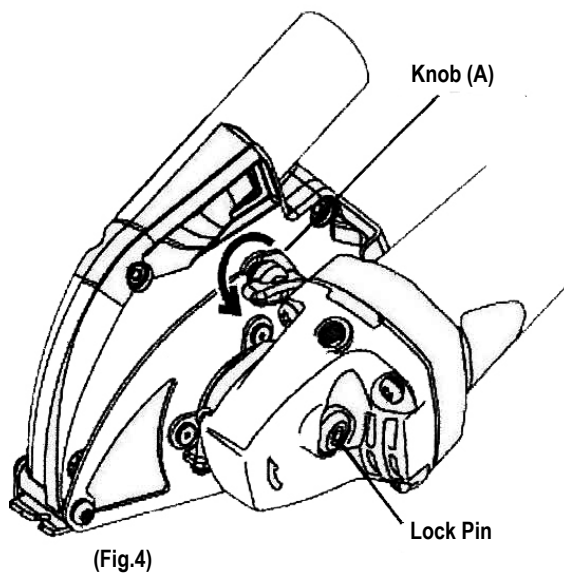

1. Loosen the Dust Collection Cover Knob (A). (Fig. 4)

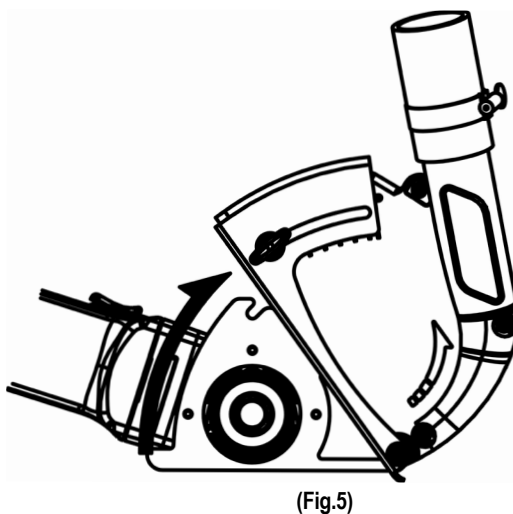

2. Slide the Dust Collection Cover open. (Fig.5)

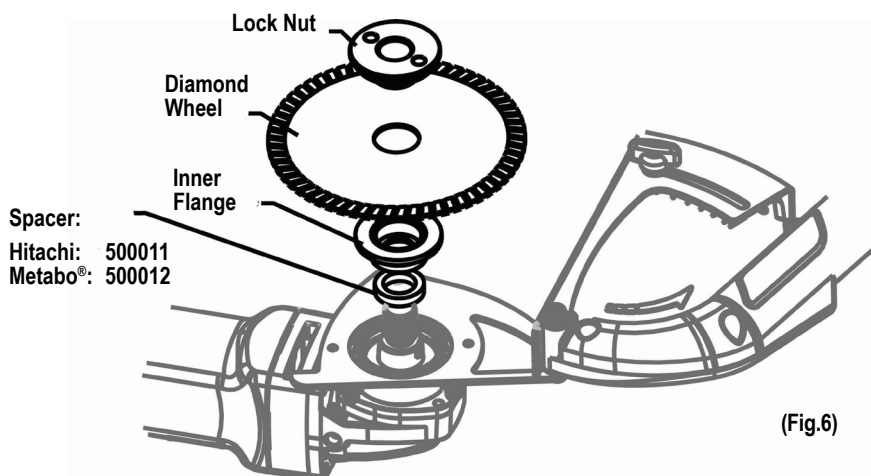

3. Mount the supplied spacer with the power tool or dedicated flange lock nut set on the spindle and then mount the diamond wheel. (Fig. 6)
4. Mount the inner flange on the spindle on top of the diamond wheel with the convex side of the inner flange on the diamond wheel side.
5. Press the lock pin to fix the spindle and securely tighten the lock nut with a pin wrench.
6. Replace the Dust Collection Cover (Fig. 4) and tighten the knob (A).

► ADJUSTING THE CUTTING DEPTH

1. Loosen knob (B) on the Dust Collection Cover. (Fig. 7)

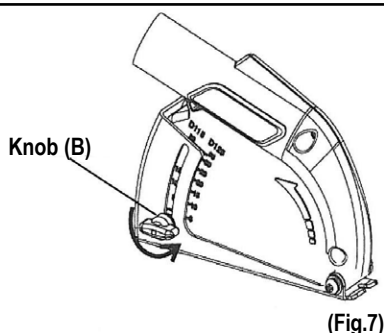

2. Slide the base plate to adjust the cutting depth and tighten knob (B) to fix the depth. (Fig. 8) Match the base plate matching surface to the scale to determine the approximate cutting depth. (Fig. 9)

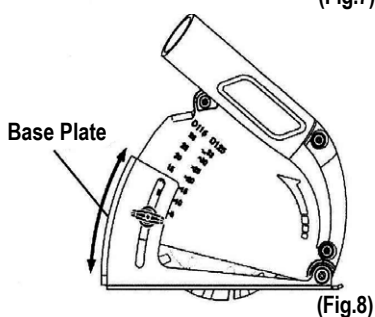

3. Use D115 scale for 4.5" (115mm) diameter blade and D125 scale for 5" (125mm) diameter blade. Cutting depth is indicated by millimeter.

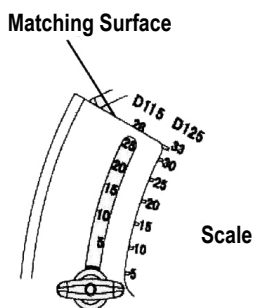

(Fig.9)

► ATTACHING THE DUST COLLECTOR

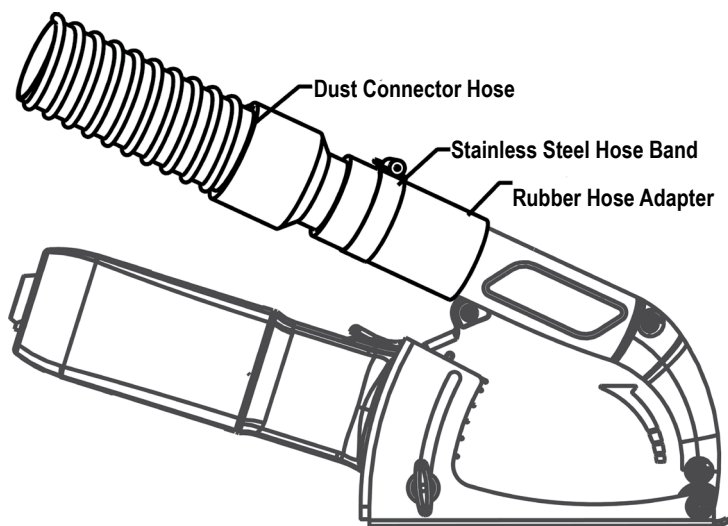

(Fig.10)

Attach the Dust Collection Cover to the hose. (Fig. 10)

*The hose opening of the Dust Collection Cover has an outside diameter of 34mm.

If necessary, use the Rubber Hose Adapter and Stainless Hose Band supplied with the Dust Collection Cover.

► ECOGUARD TYPE W SCHEMATIC

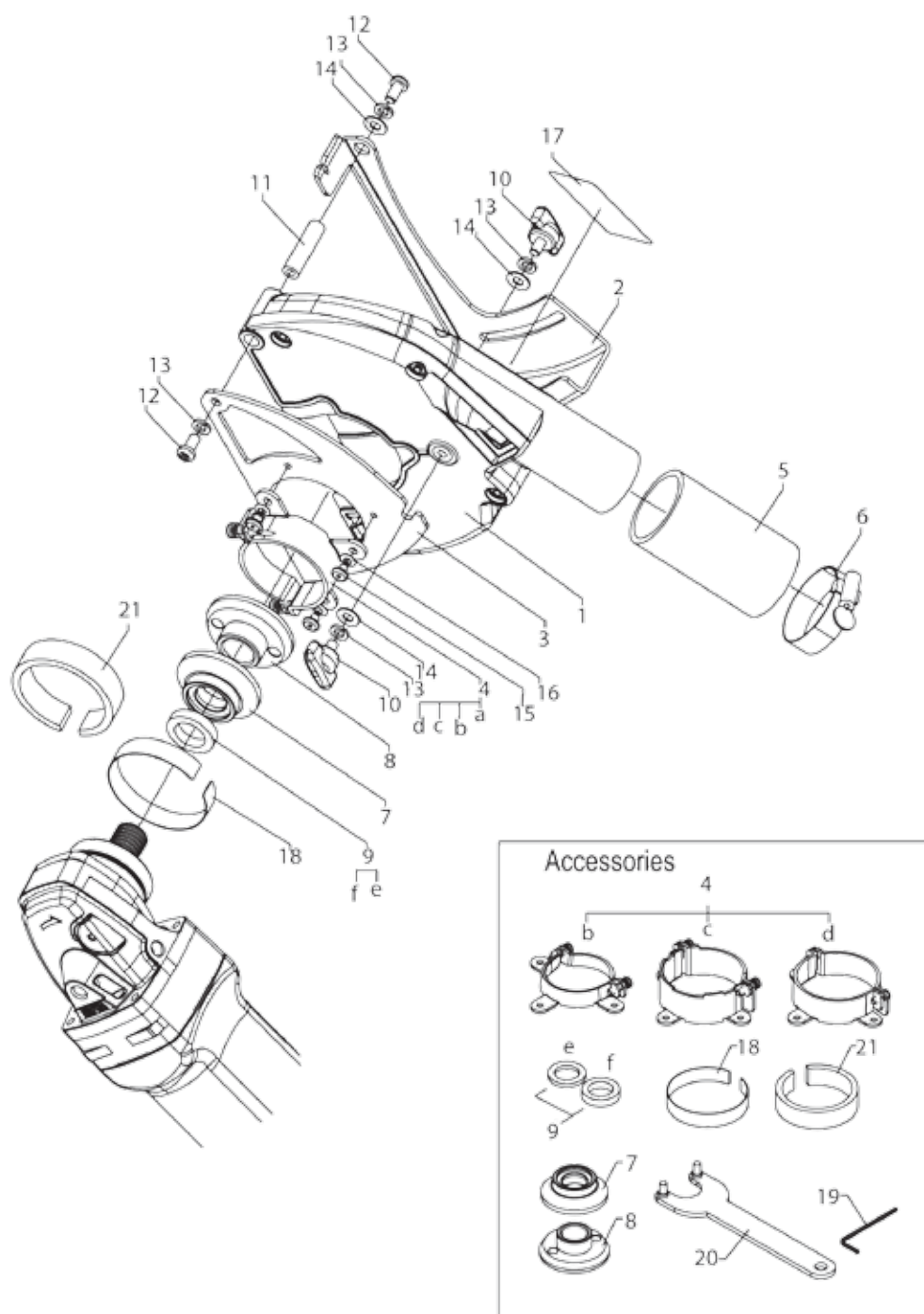

► ECOGUARD TYPE W PARTS LIST

DRAWING NO.	PART NO.	DESCRIPTION	QUANTITY
1	500027	Cover Assembly	1
2	500009	Base	1
3	500010	Base Plate	1
4a	500002	Connector Assembly (Makita ®/ Milwaukee)	1
4b	500003	Connector Assembly (Hitachi)	1
4c	500004	Connector Assembly (Metabo®)	1
4d	500027	Connector Assembly (Bosch®/Dewalt)	1
5	500005	Rubber Hose Adapter	1
6	500006	Stainless Steel Hose Band	1
7	500007	Inner Flange	1
8	500008	Lock Nut	1
9e	500011	Spacer (Hitachi/T2.5)	1
9f	500012	Spacer (Metabo®/T5.0)	1
10	500015	Knob Bolt	2
11	500016	Shaft	1
12	500017	Screw	2
13	500018	Spring Washer	4
14	500019	Washer	3
15	500020	Flat Head Screw	3
16	500021	Taper Washer	3
17	500025	Brand Label	1
18	500022	Collar - M	1
19	500024	Hex. Wrench	1
20	210105	Pin Wrench	1
21	500035	Collar D	1

Optional Accessory:

Shown on pg 4	500026	Flexible Connector Hose 18"	1
---------------	--------	-----------------------------	---

Spacer Washers (3)	If necessary, these can be used singly or in any combination to make small adjustments to the wheel so it is centered in the Ecoguard.
Shim	The rubber band shim can be used to make small adjustments to the diameter of the bearing housing of the grinder to facilitate better clamping pressure of the EgoGuard
Cable Tie	The Releasable Cable Tie should be used to tie the 1 ¼" vacuum hose to the handle of the grinder so the hose doesn't interfere with the motion of the grinder.