

# The Dust Muzzle Ultra™ Heavy Duty, 7-8"

## Installation Instructions

The Dust Muzzle™ Ultra, Heavy Duty is a universal dust collector for grinders. It can be converted to a zero clearance Dust Muzzle by raising the hinged panel on the skirt of the Dust Muzzle so the operator can grind close to a wall. It fits all round head electric and pneumatic grinders. For smaller bearing housings, the flexible ring is used. For larger diameter bearing housings, no adapter ring is necessary.

By using the spacer washers to make vertical adjustments, the Dust Muzzle Ultra can accommodate all diamond cup wheels, soft pads, polishing pads and abrasive wheels.

For Tech Support, please call 877 223-2154

### Installation Parts

- |                    |                   |
|--------------------|-------------------|
| 1. Adapter ring    | 7. Exhaust port   |
| 2. Bearing housing | 8. Spacer washers |
| 3. Fingers         | 9. Living hinge   |
| 4. Skirt           | 10. Retaining peg |
| 5. Abrasive disk   | 11. Plug          |
| 6. Hose clamp      |                   |

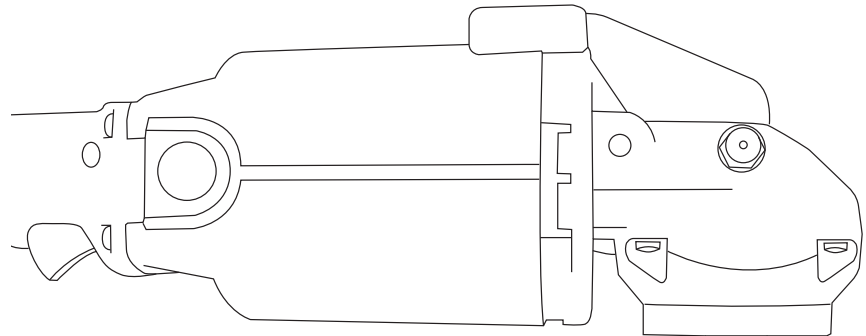
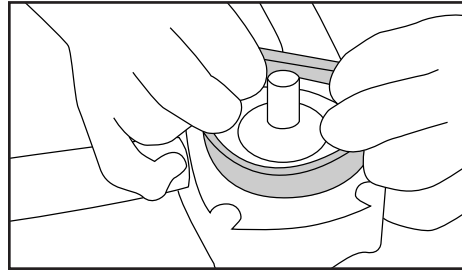

## Disconnect your grinder from its power source

1. If necessary, stretch the ADAPTER RING (1) over the BEARING HOUSING (2) of the grinder. The ADAPTER RING will not be needed on BEARING HOUSINGS (2) over 2½" in diameter.
2. Trim the FINGERS (3) so the SKIRT (4) of the Dust Muzzle extends 1/8" below the face of the ABRASIVE DISK (5). The SKIRT (4) of the Dust Muzzle should touch the work slightly before the ABRASIVE DISK (5). The easiest way to trim the FINGERS (3) is with a wire cutter. When adjusting the height of the skirt, it is IMPORTANT that the back of the abrasive wheel does not touch the inside of the Dust Muzzle.
3. Place the HOSE CLAMP (6) over the FINGERS (3) of the Dust Muzzle. Spread the fingers of the Dust Muzzle over the BEARING HOUSING (2) or the ADAPTER RING (1) (if it is used) and tighten the HOSE CLAMP (6).
5. The adjustable EXHAUST PORT (7) of the Dust Muzzle is made to accept a 1.25" male hose fitting or the 1.50" hose. The 1.25" hose is preferred because it is lightweight and will not interfere with the operation of the grinder. If a 1.25" lightweight hose is not available, the operator may remove the end fitting, normally a left-handed thread, of the standard 1.50" vacuum hose and slip the hose over the adjustable EXHAUST PORT (7).
6. Use the cable tie (supplied) to secure the vacuum hose to the handle of the grinder.

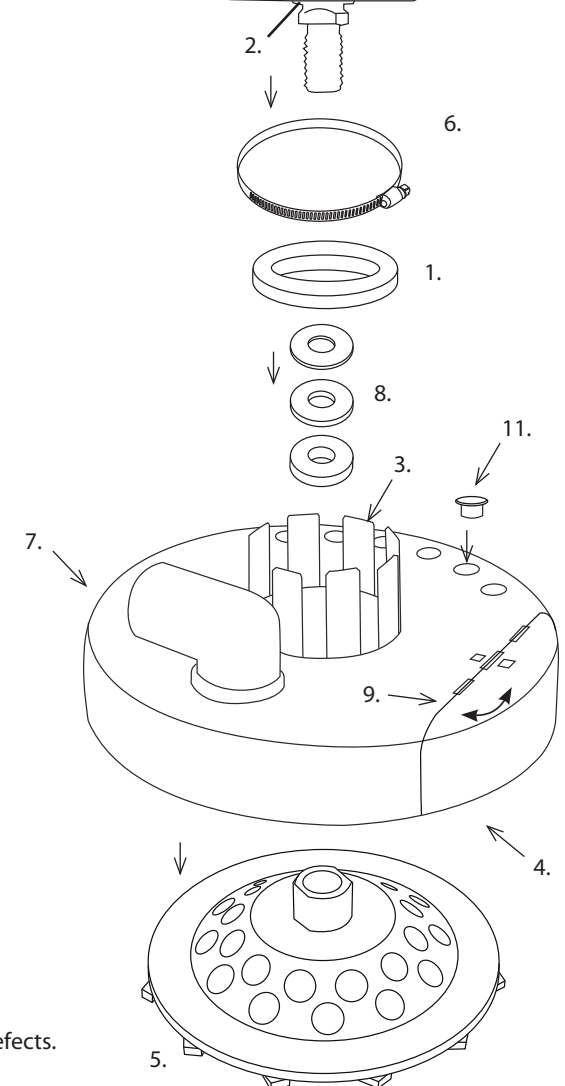

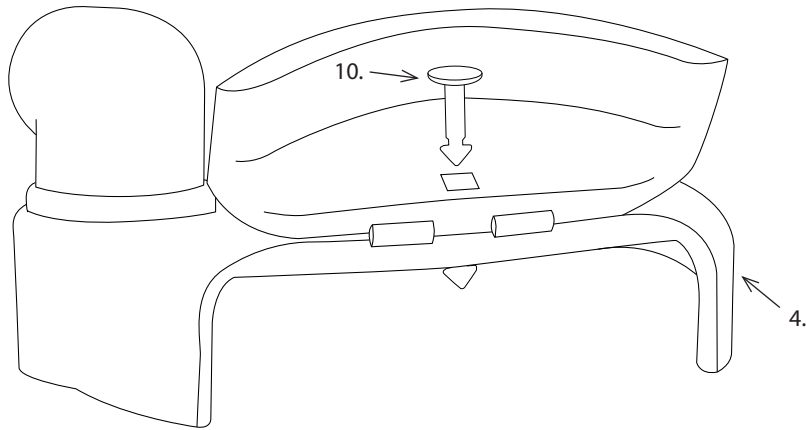

## Converting the Dust Muzzle Ultra Heavy Duty for Zero Clearance Grinding Close to Walls

### The Dust Muzzle can easily be converted for zero clearance grinding.

1. Using a scissors or a box cutter, cut the Dust Muzzle along the vertical indentations on the inside of the SKIRT (4). Do not cut through either of the two living hinges on the top of the Dust Muzzle.
2. With the SKIRT (4) in the up position, push the RETAINING PEG (10) through the corresponding rectangular holes in the hinged portion of the SKIRT (4) and the top of the Dust Muzzle. The RETAINING PEG (10) will hold the SKIRT (4) in the upright position so the grinding wheel can touch the wall.
3. If you are not receiving enough airflow through the front of the Dust Muzzle, PLUGS (11) are provided to cut off airflow through the top of the Dust Muzzle. See our notes on the vacuum requirements for the Dust Muzzle and give us a call if you need more information on the specifications for an industrial, 2hp vacuum.

## Converting the Dust Muzzle Ultra Heavy Duty Back to a Surface Grinder for the Field

1. Using a thin blade slotted screwdriver, pry the barbed end of the RETAINING PEG (10) through the rectangular hole in the Dust Muzzle body and return the SKIRT (4) to the down position.
2. Using the large rubber band, secure the liftable portion of the SKIRT (4) in the down position.

### Installation tips:

A 1.25" lightweight adapter hose is available from your retailer or online from Dust Collection Products.

Because of the different configurations of the bearing housings, it may be necessary to trim some of the FINGERS (3) to different lengths. If this is done, check that the Dust Muzzle is still firmly secured to the BEARING HOUSING (2)

The Dust Muzzle Ultra Heavy Duty is not recommended for grinders with a bearing housing (where the guard attaches to the grinder) that is less than 2.00" in diameter. These grinders include polisher/buffers with bearing housings as small as 1.625" in diameter. Ask your retailer to contact us for a list of Original Dust Muzzles that will fit these grinders. A cross reference is listed below.

The Dust Muzzle will work with any vacuum but for optimum results, the operator should use a vacuum that has: 1) Removable filter bag 2) 90 cubic feet per minute airflow 3) At least 90" of static lift. Call us for knowledgeable technical support at 877 223-2154.

### Use the Original Dust Muzzle (717 or 817) for these grinders

BRAND	MODEL	7"	8" & DIAMOND CUP WHEELS
BLACK&DECKER	4042	717	817
BLACK&DECKER	9513	717	817
HITACHI	GF30	717	817
HITACHI	SP18T	717	817
MAKITA	9217SPC	717	817
MAKITA	9218SB	717	817
MAKITA	9564	717	817
MAKITA	9227C	717	817

The Dust Muzzle is unconditionally guaranteed against manufacturers defects.

Patents Pending